

Petrol ECU side

- 1)[A2] grey-black
- 2)[A3] yellow-black
- 3)[A4] purple-black
- 4)[A5] blue-black

ID 0240201XX

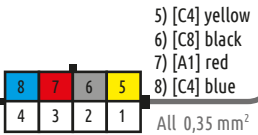
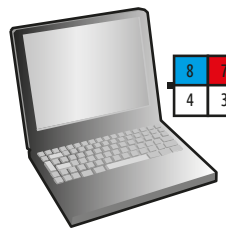
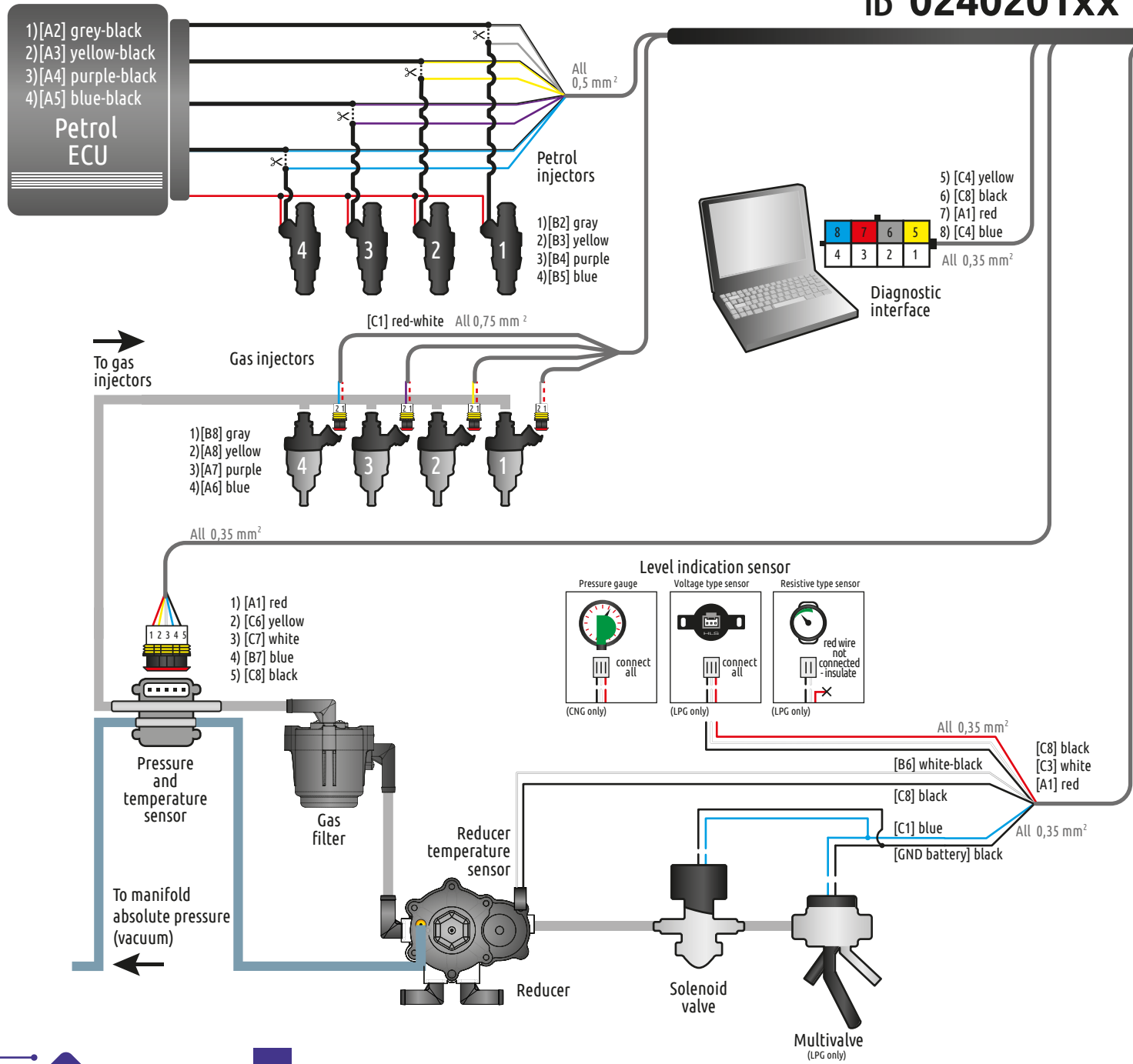

A1	+12V (interface mapsensor gas level)
A2	Petrol Injector 1 (petrol ECU side)
A3	Petrol Injector 2 (petrol ECU side)
A4	Petrol Injector 3 (petrol ECU side)
A5	Petrol Injector 4 (petrol ECU side)
A6	Gas Injector 4
A7	Gas Injector 3
A8	Gas Injector 2
B1	+12V from battery
B2	Petrol Injector 1 (injector side)
B3	Petrol Injector 2 (injector side)
B4	Petrol Injector 3 (injector side)
B5	Petrol Injector 4 (injector side)
B6	Switch bottom/Reducer temperature
B7	Manifold absolute pressure (Vacuum)
B8	Gas Injector 1
C1	+12V (gas injectors, solenoid valves)
C2	+5V switch power supply
C3	Gas level indication sensor
C4	Diagnostic interface Rx/Tx
C5	Switch DATA
C6	Gas temperature
C7	Gas absolute pressure
C8	GND battery

